



CONCERTINA I

1,630 total square feet

3 Br, 2.5 Ba

The concertina is an instrument that was very popular in the middle and late 1800's and early 1900's in rural America. This 'working class' instrument was brought over by German immigrants and easily found its way to America's first family farms.

The Concertina Farmhouse by MossCreek is a reimagined version of the farmhouses of the early 1900's. Minimalist modern elements combine nicely with a historic farmhouse massing.

The design features open living areas and master suite with beamed ceilings on the main level. The vaulted ceiling of the great room lets dramatic light fill the home. On the upper level the home features two pleasant guest rooms, and a shared bath.

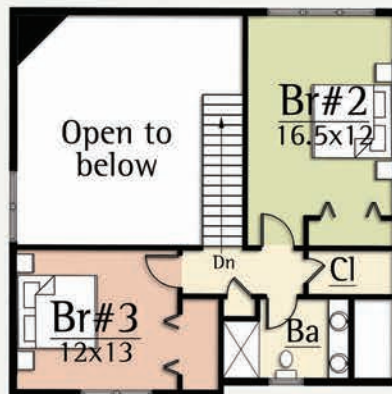

Upper Level
606 square feet

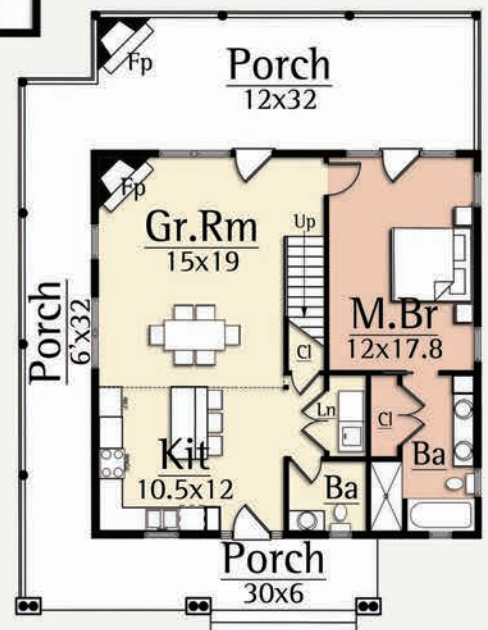

Main Level
1,024 square feet

